

Case Order  
Doc 45470 re: Conservation  
Easement

SUBDIVISION PLAN OF LAND IN NANTUCKET

Hayes Engineering Inc., Surveyors

October 31, 1984

13554<sup>E</sup>  
(Sheet 1 of 4)

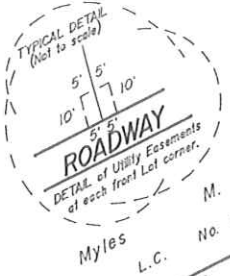
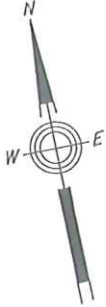

Raymond  
Foulikrod  
et ux.  
L.C. No. 289334  
Cert. No. 5520

Subdivision of Lots 5 and 6  
Shown on Plans 13554<sup>C</sup> and 13554<sup>D</sup>  
Filed with Cert. of Title Nos. 11402 and  
Registry District of Nantucket County

Separate certificates of title may be issued for land  
shown hereon and on Sheets 2 thru 4 as Lots 22 thru 106  
By the Court.

*Charles Crowley*  
Recorder

DEC. 26, 1985  
MPG

Abutters are shown as on  
original decree plan.

Copy of part of plan  
filed in  
LAND REGISTRATION OFFICE  
DEC. 26, 1985  
Scale of this plan 100 feet to an inch  
Louis A. Moore, Engineer for Court

THIS PLAN FILED WITH CERTIFICATE NO. 11,402